

## Rectangle Cutter Knife Head

### Functional Parts

- 1) Knife insertion knob
- 2) Knife release knob.
- 3) Index handle.
- 4) Index pin.
- 5) Index washer.
- 6) Knife depth screw.
- 7) Thumb nut.
- 8) Knife clamp.
- 9) Pressure foot.
- 10) Blade support screw.
- 11) Mat thickness gauge.

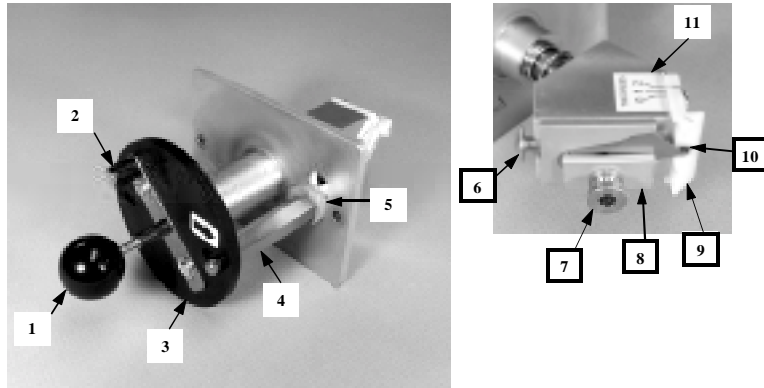

### Blade Installation

- 1) Remove the thumb nut, clamp plate, and old blade.
- 2) Install the new blade so that it seats against the back of the knife pocket.
- 3) Install the clamp plate and tighten the thumb nut firmly by hand. **Do not use pliers.**

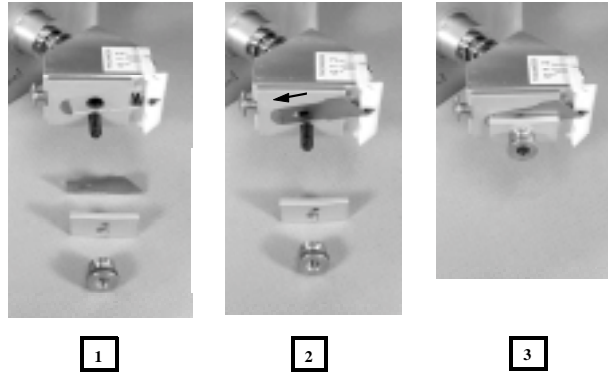

### Blade Depth Adjustment

- 1) Press on knife insertion knob until blade locks in cut position.
- 2) Place the depth gauge on the flat surface of the pressure foot.
- 3) Adjust depth screw so blade point is exactly one mat thickness above the foot surface.
- 4) Press the knife release knob towards the center of the index handle to place the knife in the out position.

